

REVISION RECORD			
REV.	CONTENT	MOD.	DATE
△	初版发行		

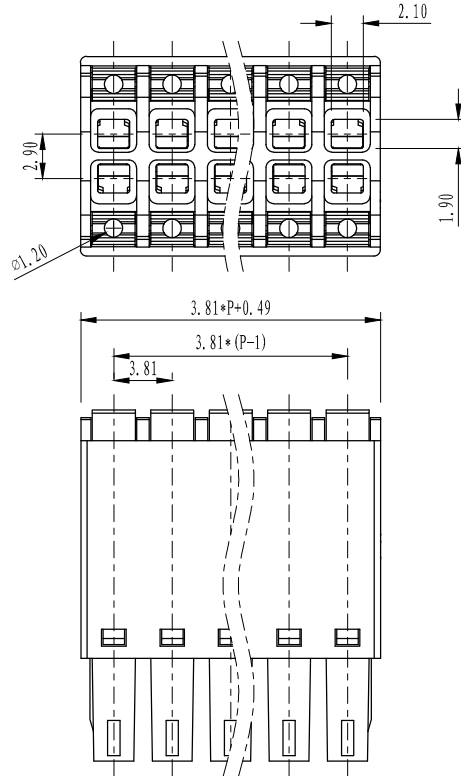

NOTES:

1. Voltage Rating: 300V, Current Rating: 8A
2. PITCH: 3.5mm
3. Insulation Withstands Voltage: AC2500V/min
4. Using Temperature Range: -40°C - +105°C
5. Suitable Electric Wire: 28-16AWG
6. strip length:8mm

技术要求:

1. 额定电压: 300V, 额定电流: 8A
2. 间距: 3.5mm
3. 耐受电压值: AC 2500V/min
4. 使用条件: -40°C - +105°C
5. 适用线规: 28-16AWG
6. 剥线长度: 8mm

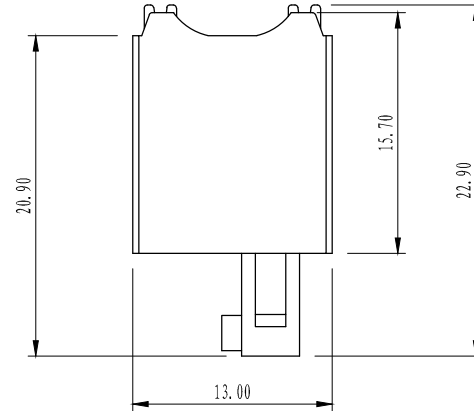

	pitch dimension			Nominal dimension					— /
	over 0 to 6	over 6 to 10	over 10 to 24	over 0 to 30	over 30 to 60	over 60 to 100	over 100 to 150	0.05/10	
variable range	0 to 6	6 to 10	10 to 24	0 to 30	30 to 60	60 to 100	100 to 150	0.05/10	
Tolerance	±0.1	±0.15	±0.25	±0.2	±0.3	±0.5	±0.7	±1.0	

4	LC6-5.08-按钮	1020D0YXXAV	2P	POM	
3	LC84-3.5-夹子导电件弹片	LC84-3.5-夹子导电件弹片	P		
2	LC84-3.81-盖板	1194C0YXXAV	1	PA66	
1	LC84-3.81-主体	1194A0YXXAV	1	PA66	
NO.	NAME OF PART	NO. OF PART	Q'TY	MATERIAL	NOTES
DES.	陈明珠	DATE	2024/06/21	UNITS	MM
CHK.		DATE		SIZE	A4
APP.		DATE		SCALE	1:1
				TITLE	LC84-3.81-XXP-1Y-00A LC84-3.81-成品

THIRD ANGLE PROJECTION	SHEET	1 of 1
DWG NO.	SP-1-1020006	REV: V0