

REVISION RECORD		
REV.	CONTENT	MOD. DATE
①	初版发行	

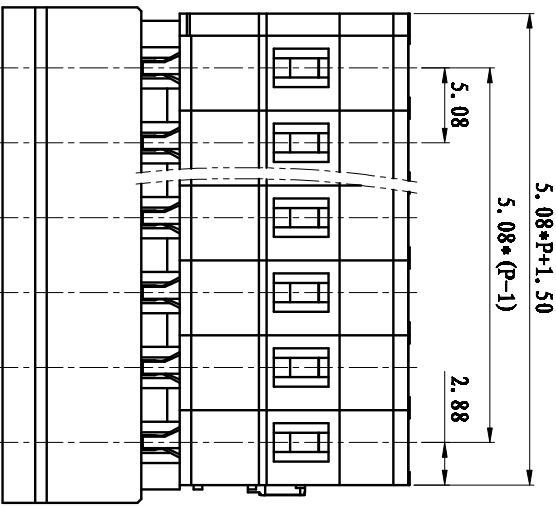

NOTES:
 Pitch: 5.08mm
 Rated Voltage: 300 V
 Rated Current: 15 A
 Withstand Voltage: AC2500V for 1 minute
 Insulation Resistance: 500MΩ / DC500V
 Using Temperature Range: -40°C ~ +105°C
 Wire range: 22~14AWG

技术要求:
 间距: 5.08mm
 额定电压: 300V
 额定电流: 15A
 耐压值: AC2500V/min
 绝缘阻抗: 500MΩ/DC500V
 使用条件: -40°C~+105°C
 适用线规: 22~14AWG

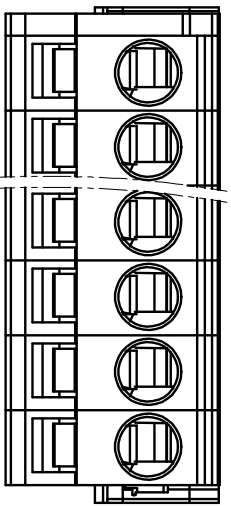
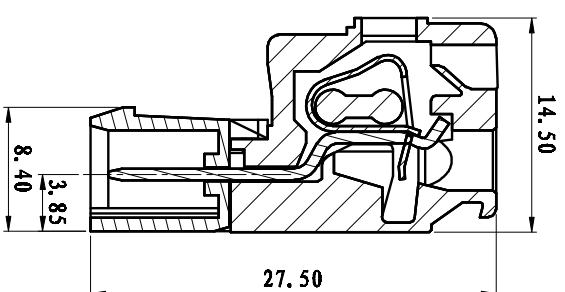

	pitch dimension			Nominal dimension					Tolerance
	over	over	over	over	over	over	over	over	
variable range	0 to 6	6 to 10	10 to 24	0 to 30	30 to 60	60 to 100	100 to 150	150 to	0.05/10
	±0.1	±0.15	±0.25	±0.2	±0.3	±0.5	±0.7	±1.0	0.05/10

5	LSC10-方针	1062B0001AV	P	黄铜	镀雾锡
4	LSC1-薄片	F2A0DI-SLCTBY	P	不锈钢	
3	LSZ10-5.08-主体	1086A0YXXAY	1	PA66	
2	LSC10-5.08-盖板	1062C0Y01AY	1	PA66	
1	LSC10-5.08-本体	1062A0Y01AY	P	PA66	
NO.	NAME OF PART	NO. OF PART	QTY	MATERIAL	NOTES
DES.	LDD	DATE	2012/08/15	mm	THIRD ANGLE PROJECTION
CHK.	DATE	SCALE	A4	SIZE	SHEET
APP.	DATE	SCALE	1:1	SIZE	1 of 1
				DWG NO.	SR-2-1066002
				TITLE	LSZ10-5.08-XP-1T-00A
				TITLE	LSZ10-5.08-成品

上海联捷电气有限公司
 Shanghai Einker Electric CO.,LTD